



# Zarzamora/Military Prímo Transit Improvements



# PRIMO Service Plans

- ▶ Two new Primo routes are proposed to connect with the existing Route 100 on Fredericksburg Road:
  - » **SW Military Drive:** overlays Route 550/551
  - » **Zarzamora Street:** overlays Route 520
- ▶ Both routes will have improved frequency of service

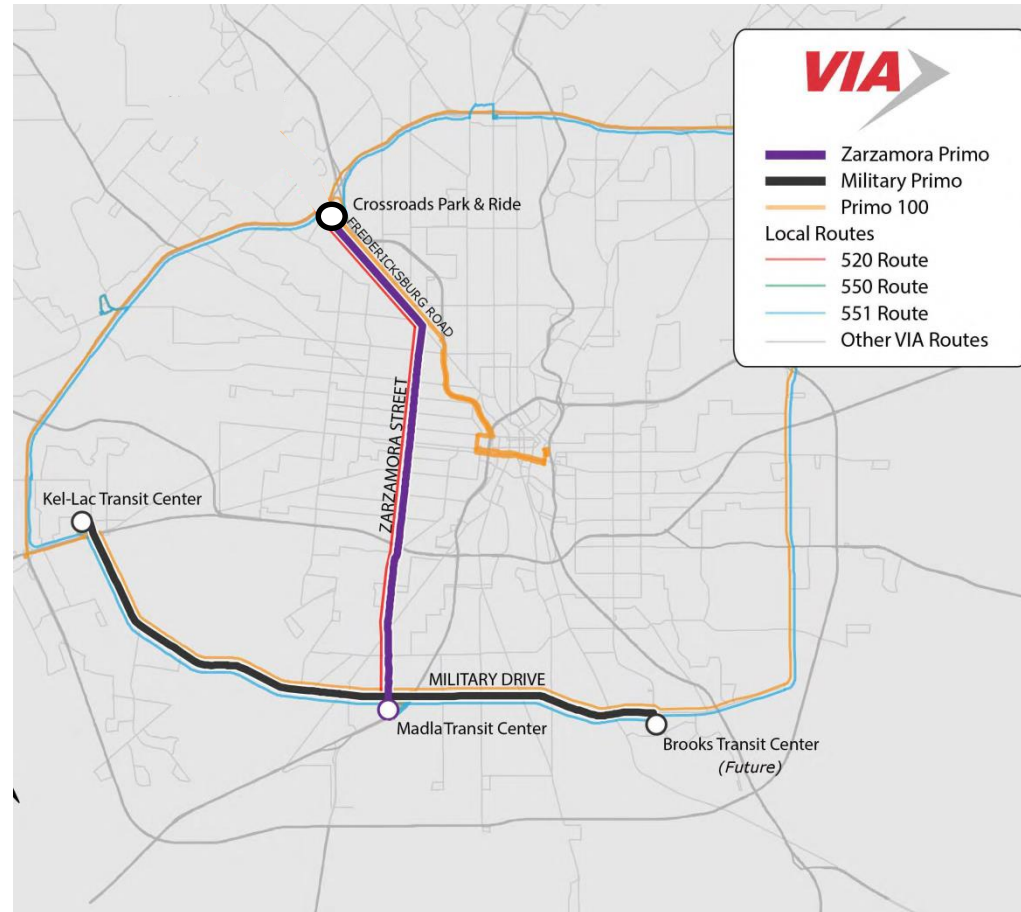

# Primo Corridor Projects

## Zarzamora & Military Primo

- ▶ Separate routes
- ▶ Connections; Madla, Kel-Lac, Brooks transit centers
- ▶ Zarzamora will extend service on Fredericksburg Road to the Crossroads Park & Ride facility

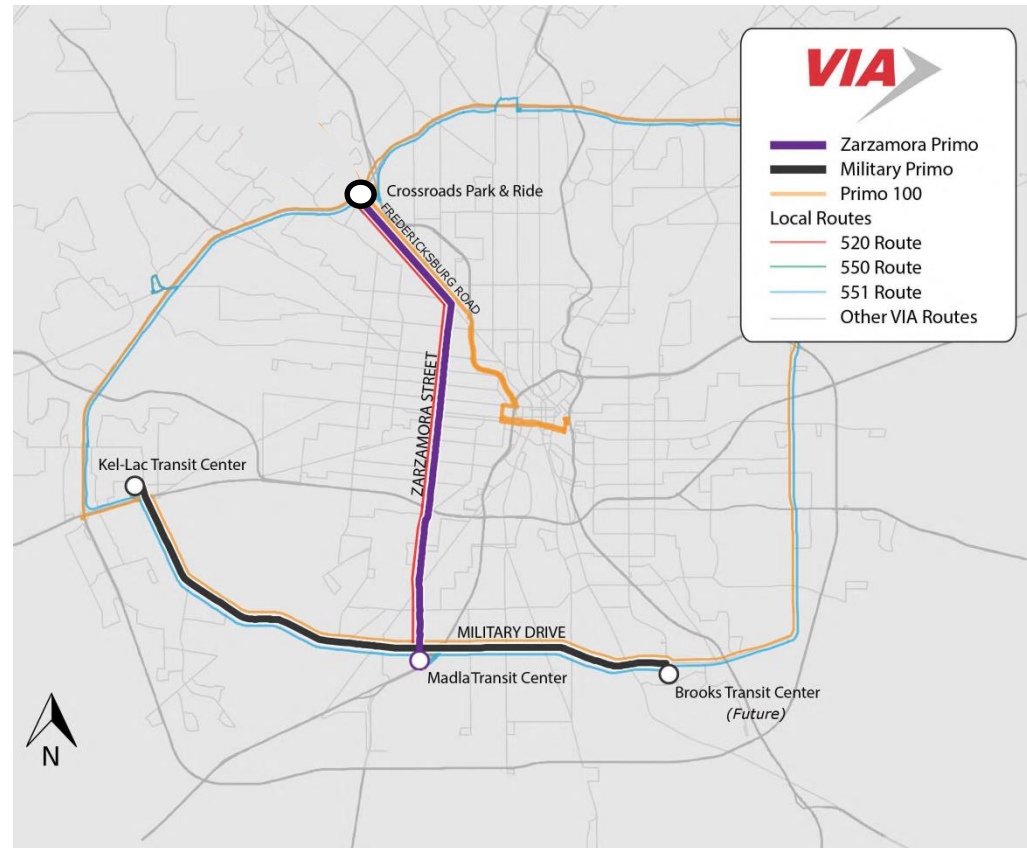

# Bus Stop Accessibility & Amenities

- ▶ Sidewalk rehab and replacement
- ▶ Curb cuts/ramps
- ▶ Crosswalks
- ▶ Bike amenities



# Public Engagement



# Next Steps

---

Environmental Findings Late Spring 2016

Final Design 30-60%

Construction Documents 2016

Construction 2017/2018

**ART CONTEST**  
2017/2018

Start Service 2018/2019

*Continuous Public Engagement*

# Primo Shelter Locations

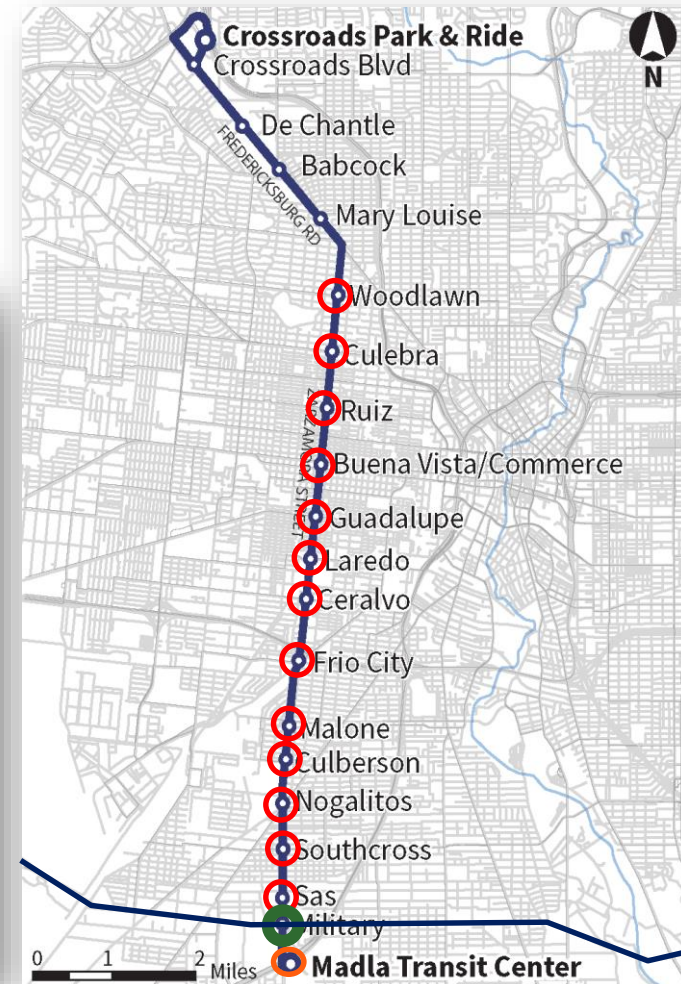
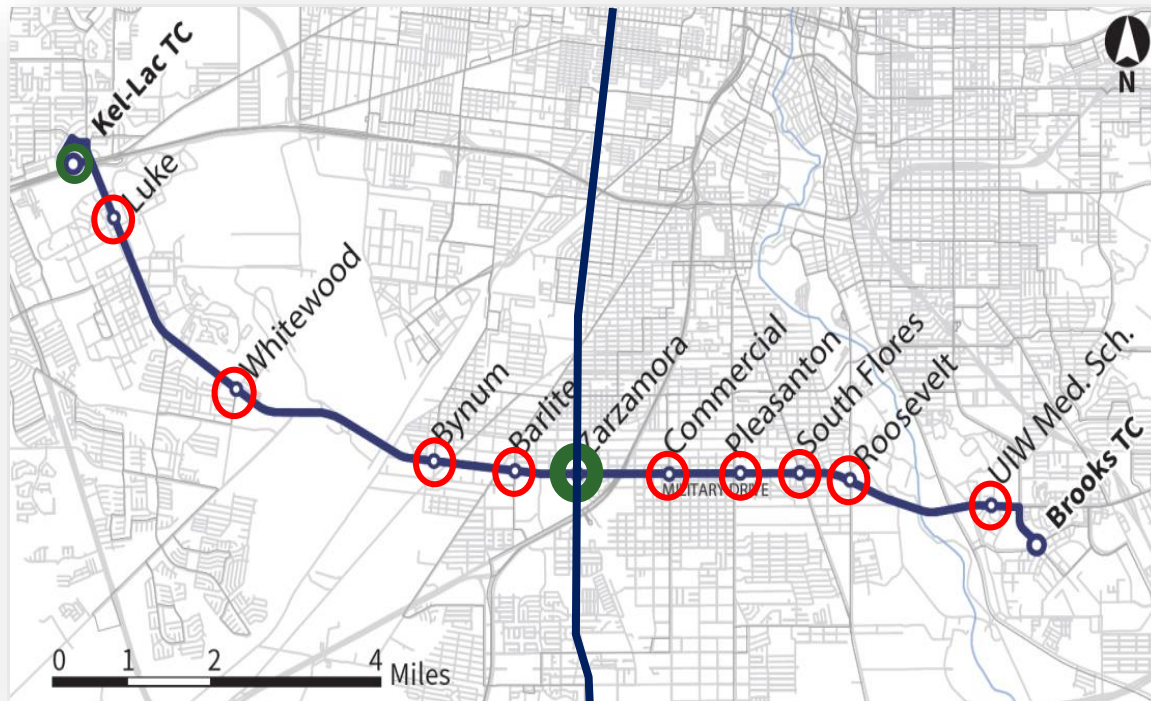

# Primo Shelter Type (Standard) 32 Shelters w/ 3 Panels

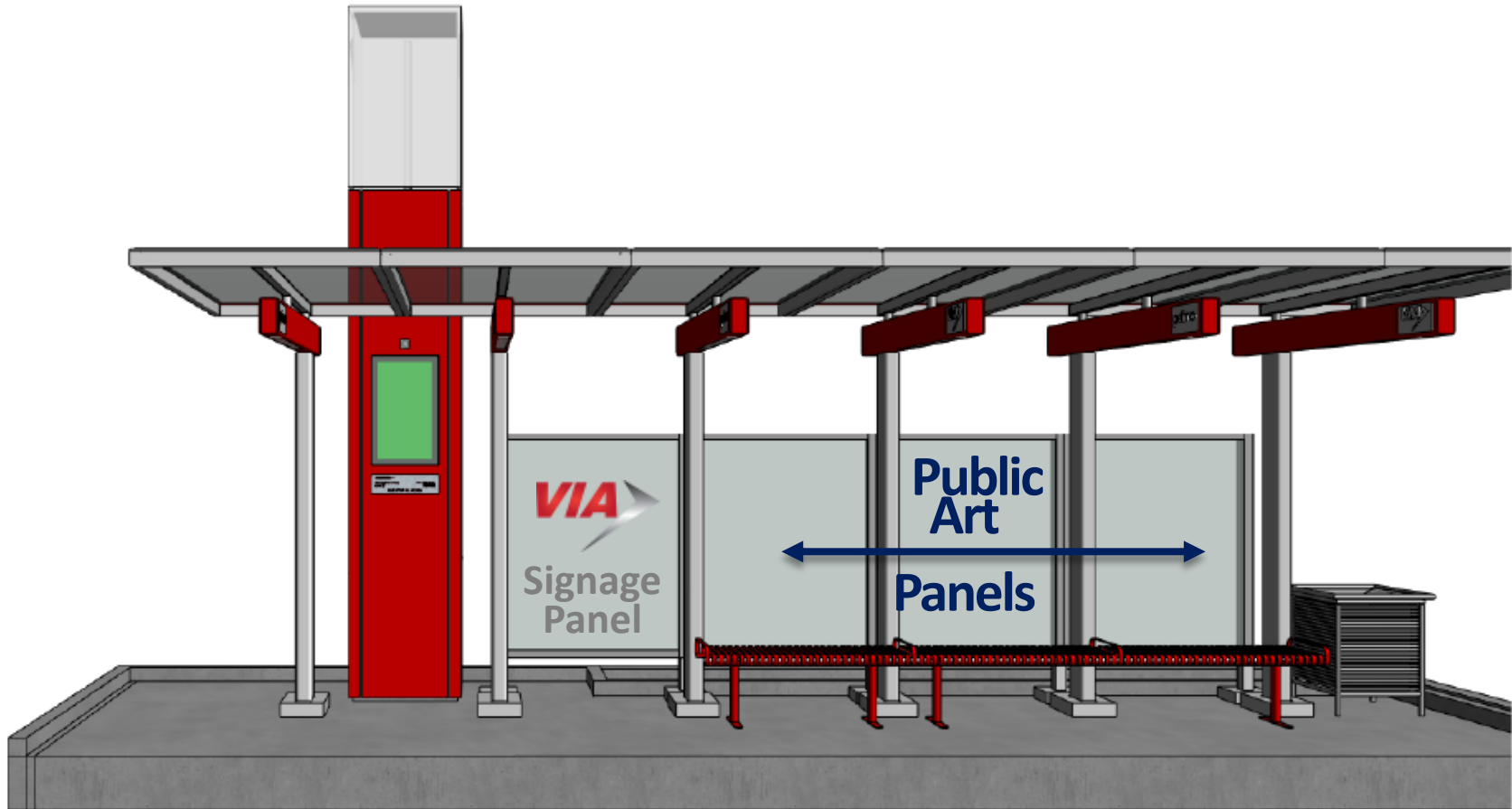



# Primo Shelter Type (Narrow) 12 Shelters w/ 4 Panles

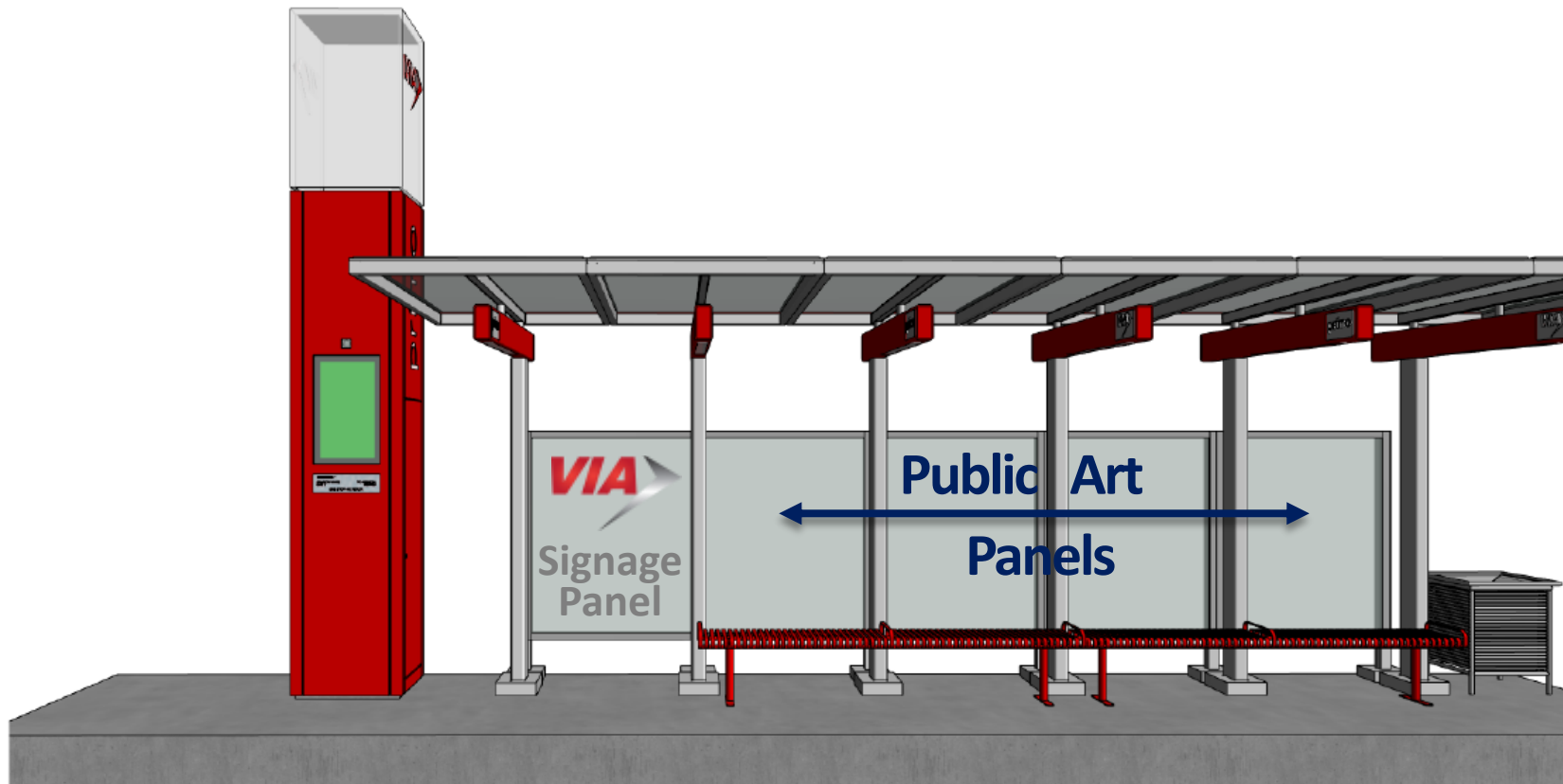

# Primo Shelter Type (Special)

- 1 Station w/ 3 shelters-5 panels
- 1 Station w/ 5 shelters-3 panels

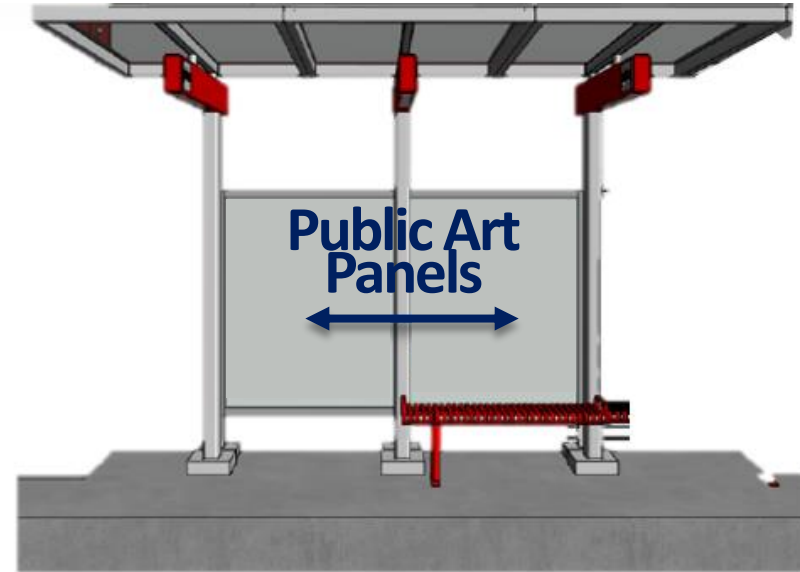
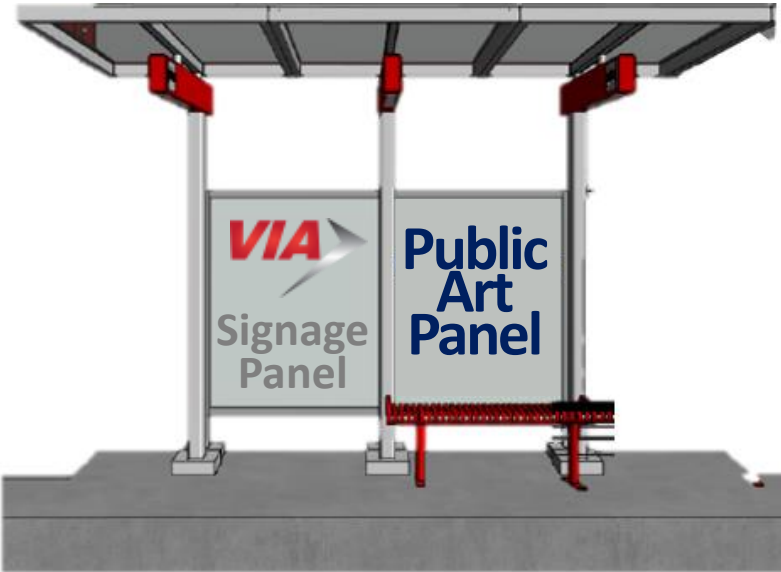

# Kel-Lac Transit Station

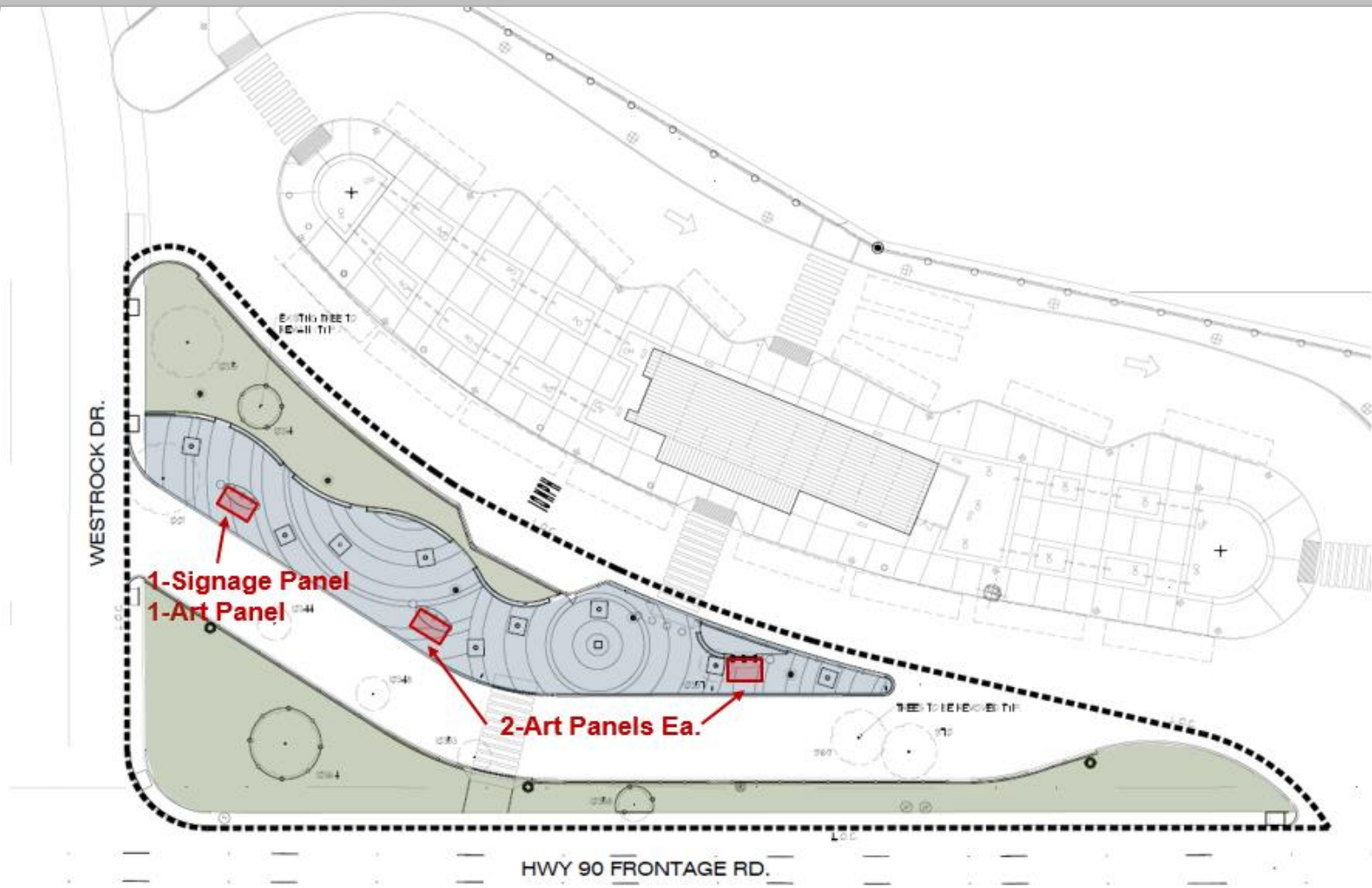

# Zarzamora/Military Intersection



# Plan View

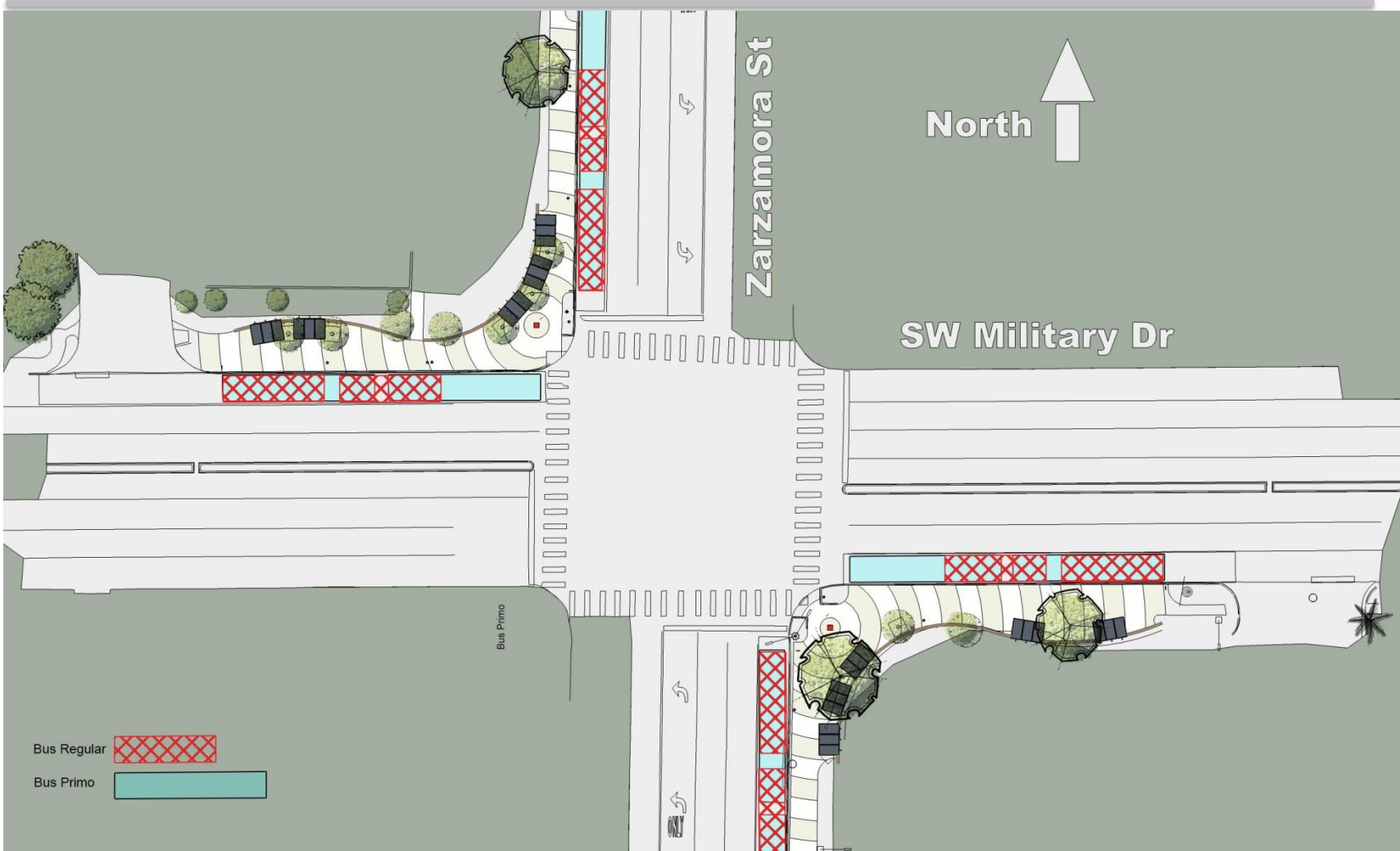

# Bird's Eye View



# View at NW corner

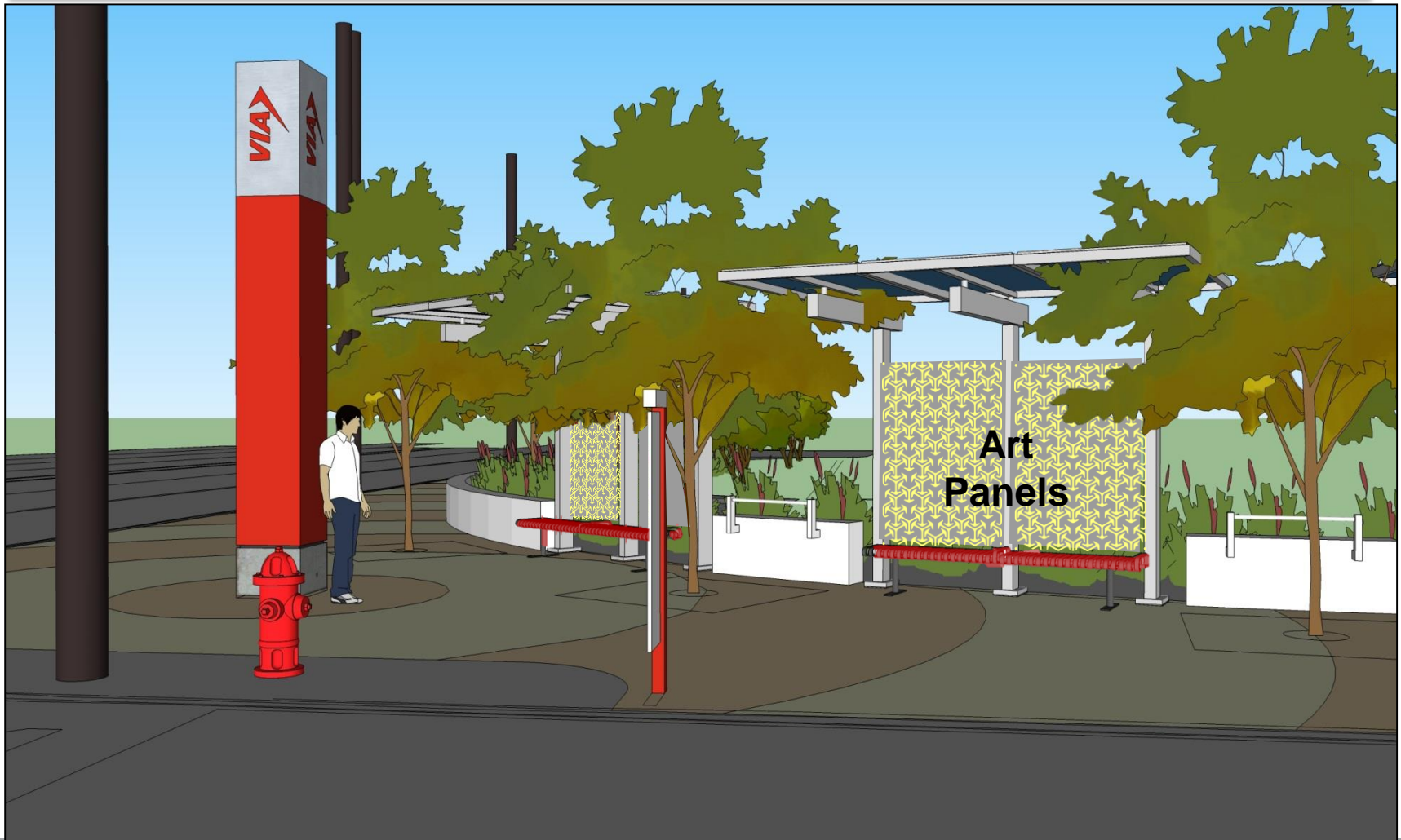

# Elevation: looking South on Zarzamora

